

STUDER
PROFESSIONAL AUDIO EQUIPMENT

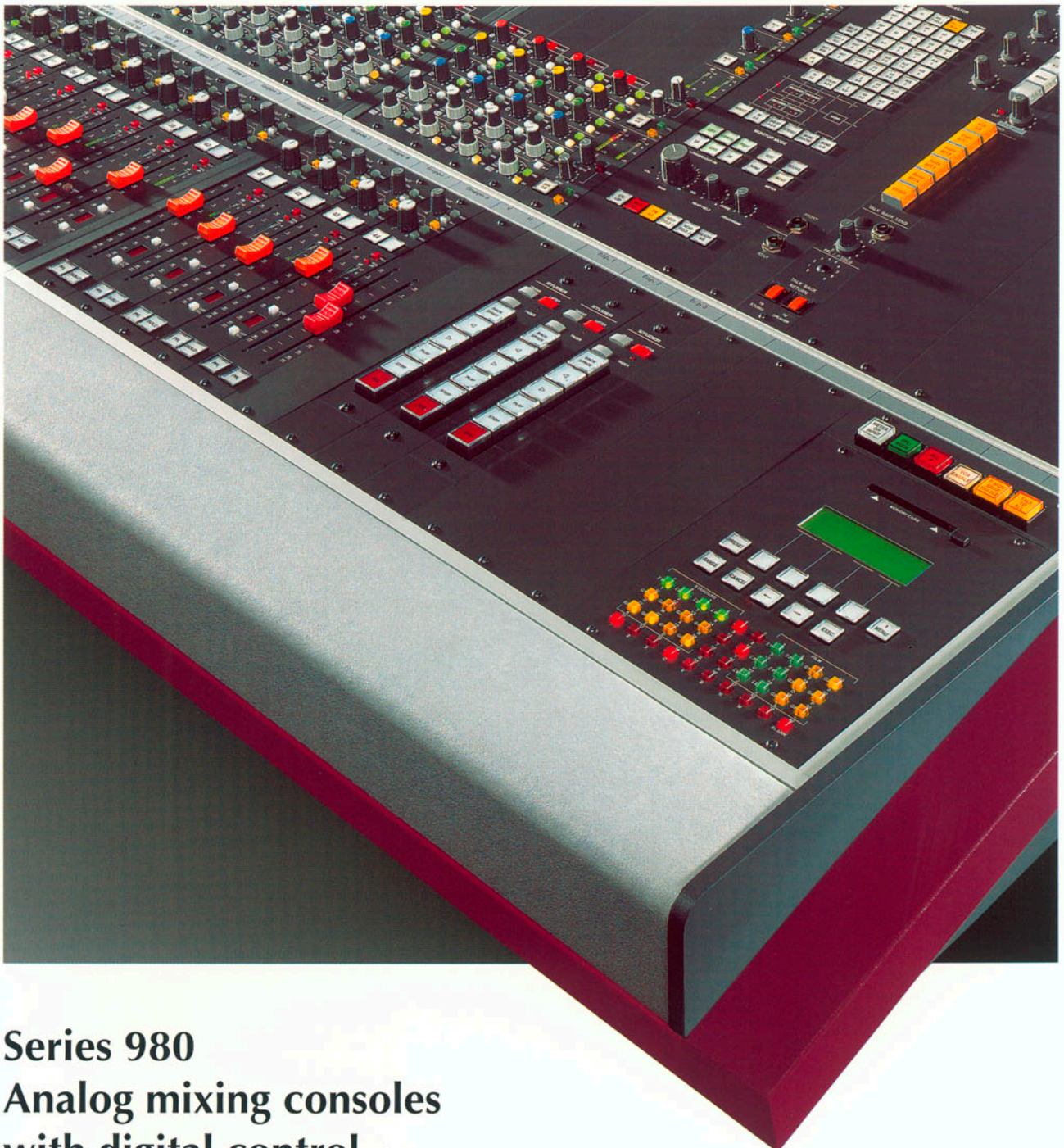

Series 980
Analog mixing consoles
with digital control

STUDER Series 980 - The future of the analog audio mixer technology

In the age of multichannel sound in films and television and at the dawn of multimedia technology, a completely new level of audio mixing performance is required. But also the «traditional» field of radio broadcasting has changed its requirements profile; direct and «n-1» outputs per channel are nowadays taken for granted. In addition, a large number of special requirements must be met.

STUDER offers the perfect answer: the 980 family of mixing consoles. Eight different types of input channels, four to six master buses, and almost 200 different special modules are available for configuring a system to any application



requirement. And the renowned audio quality of the STUDER mixing consoles has again been demonstrated by the newly developed microphone input stage.

A novel concept is the «top layer» automation that functions either statically (snapshot automation with information stored on a PCMCIA card the size of a credit card) or dynamically as an option (faders and mutes) with time code control. «Top layer» means «superposed»; that is, the mixing console can also be operated manually without automation (or if the automation system is defective).

This brochure illustrates the principal elements in the format 1:1 so that you can get an accurate picture of how functionally the controls and modules are arranged on the STUDER 980 series.

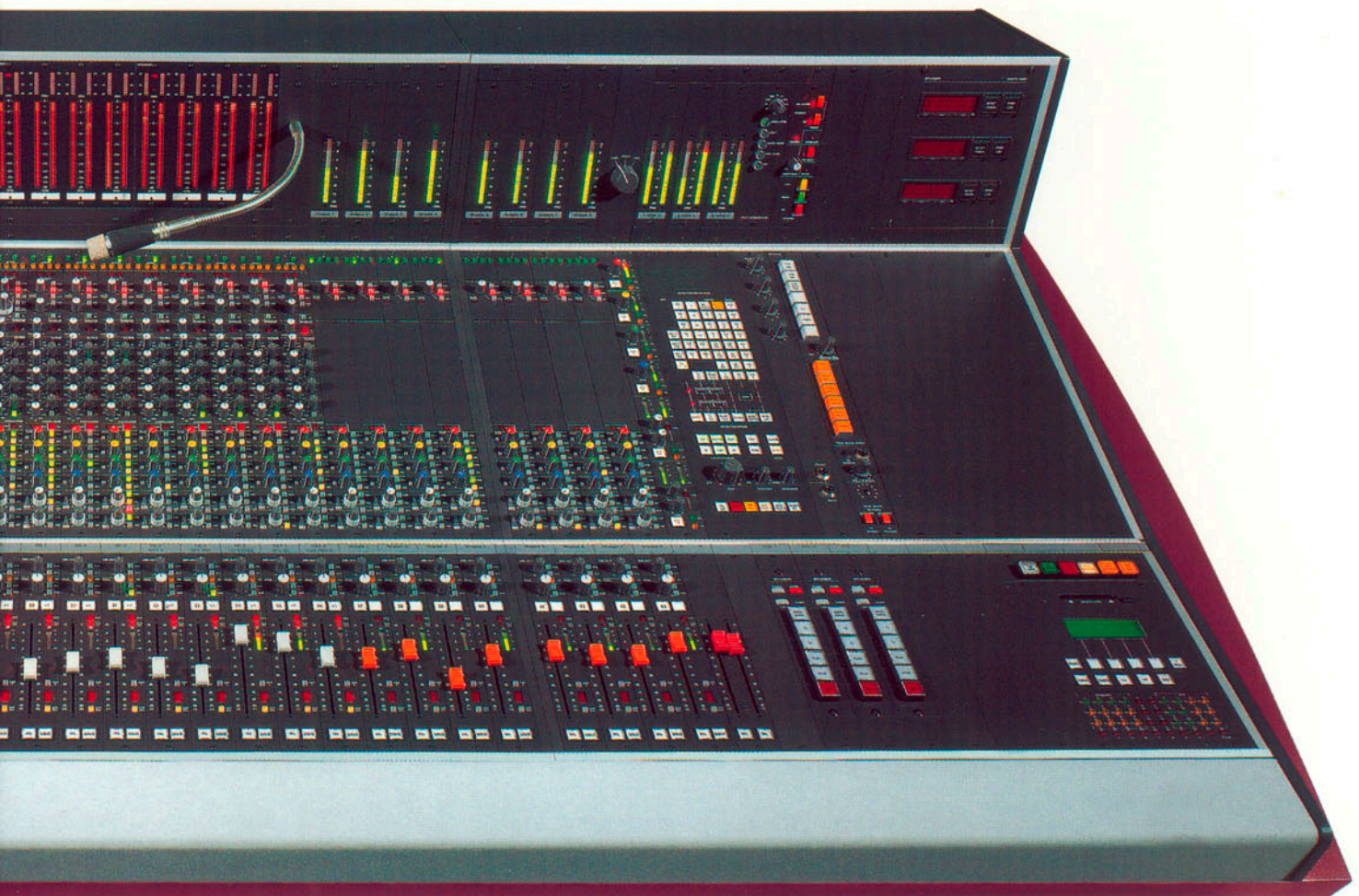

Instruments

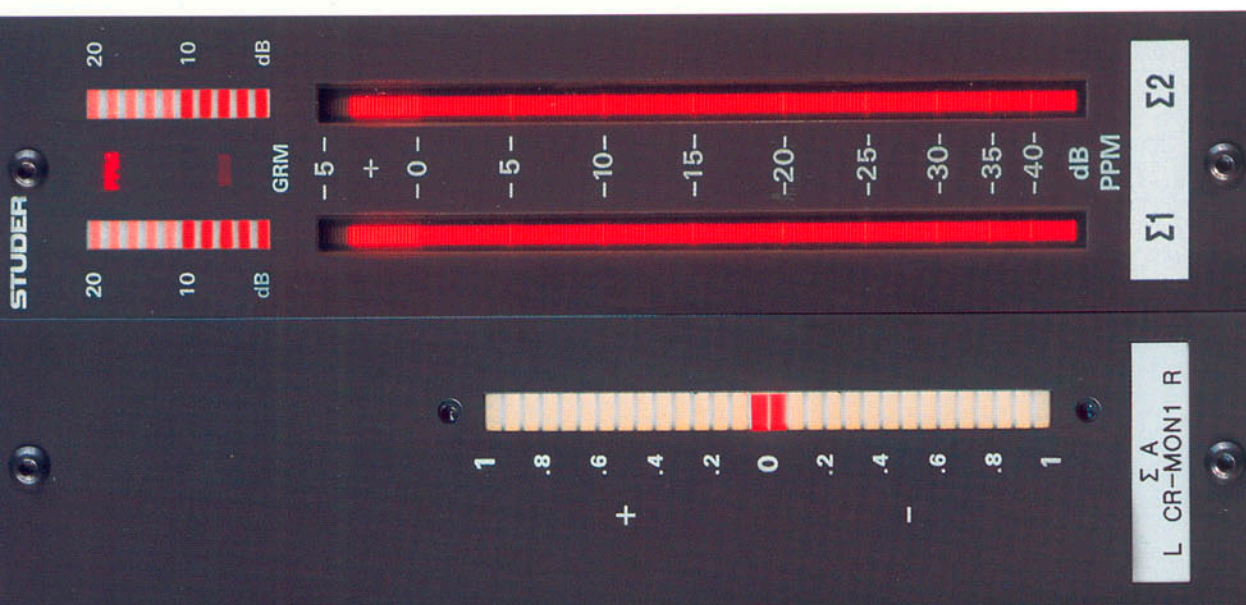

Instruments

(from top to bottom):

Stereo bargraph (with separate gain reduction meters) 1.913.111

LED-type correlation meter 1.913.109

LED-type mono level meter 1.913.101

LED-type stereo level meter (VU) 1.913.106

LED-type stereo level meter (PPM) 1.913.105

VU meter with gain reduction meter 1.913.231

Other instruments:
See under «Special units»

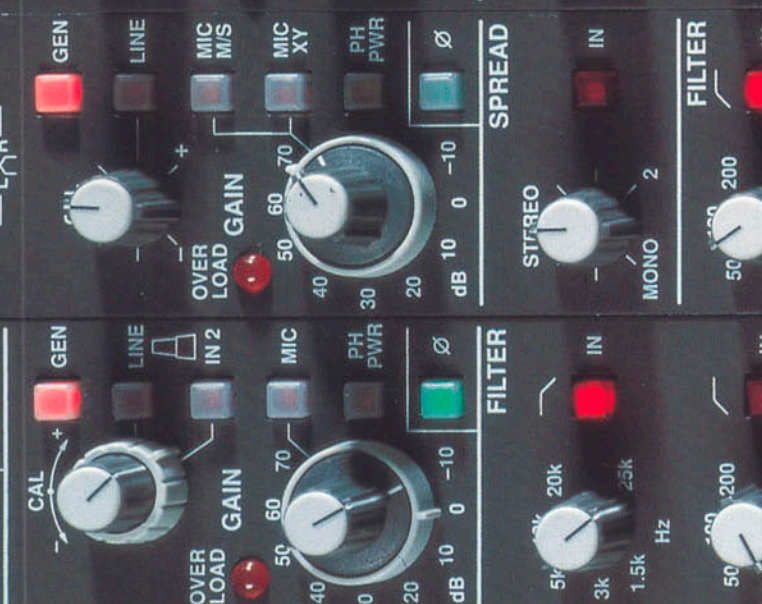
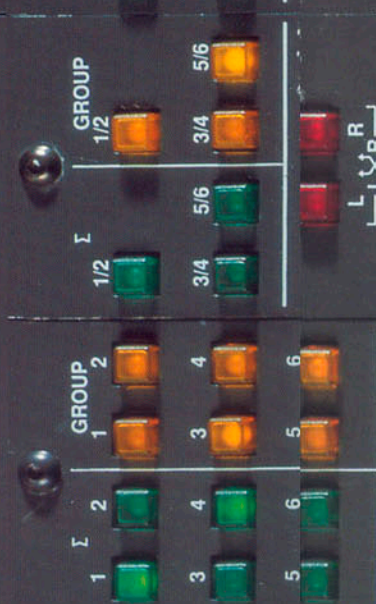
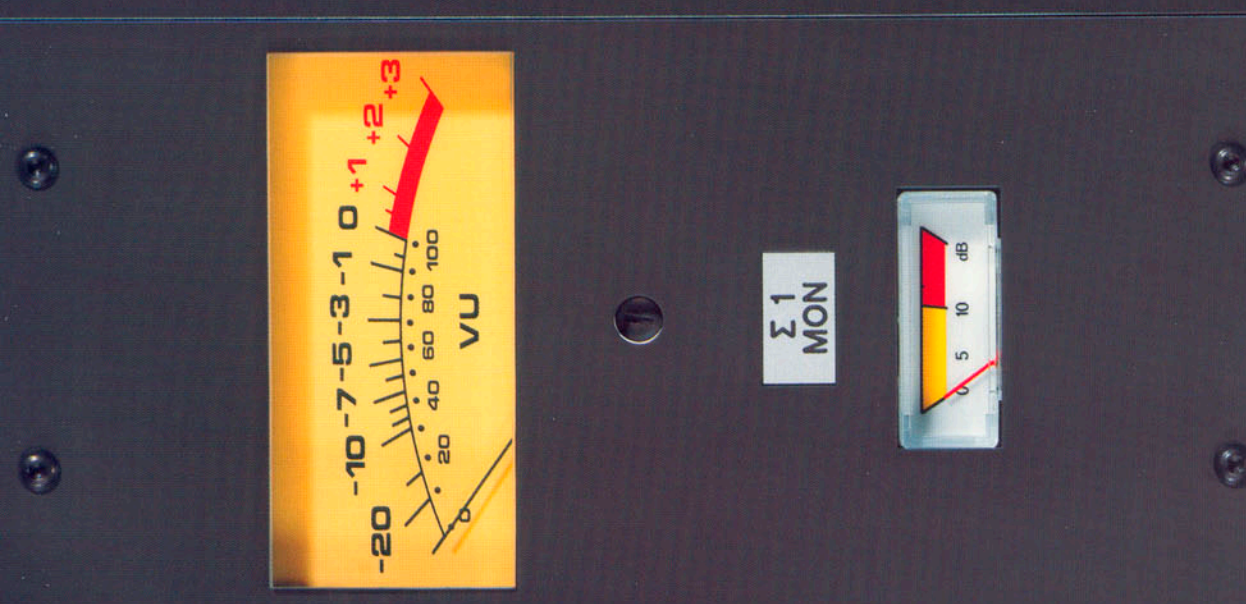
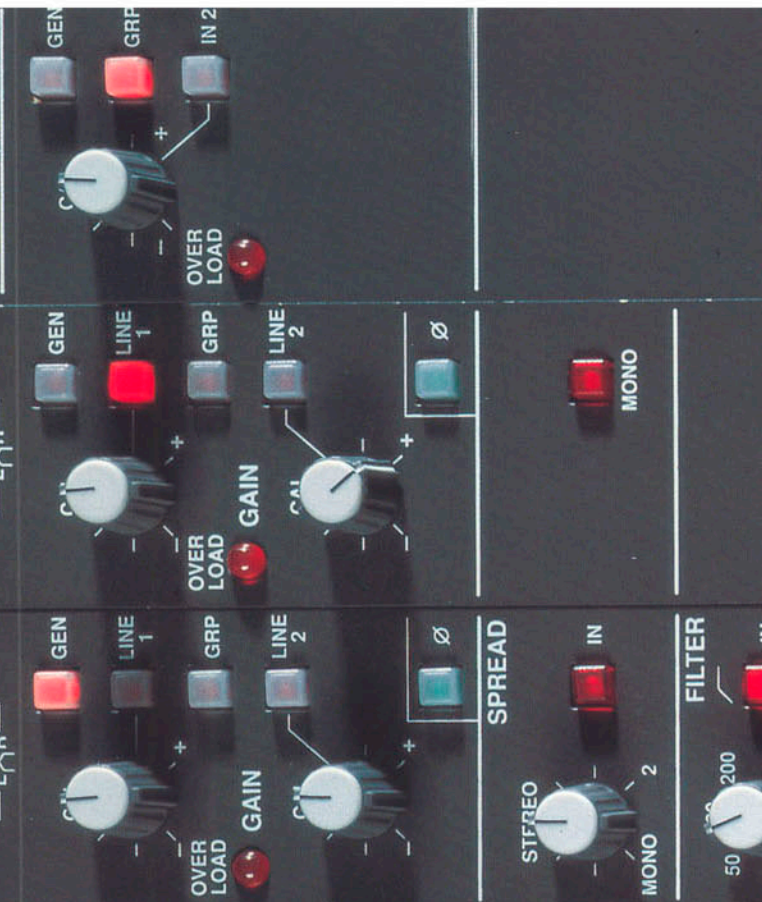
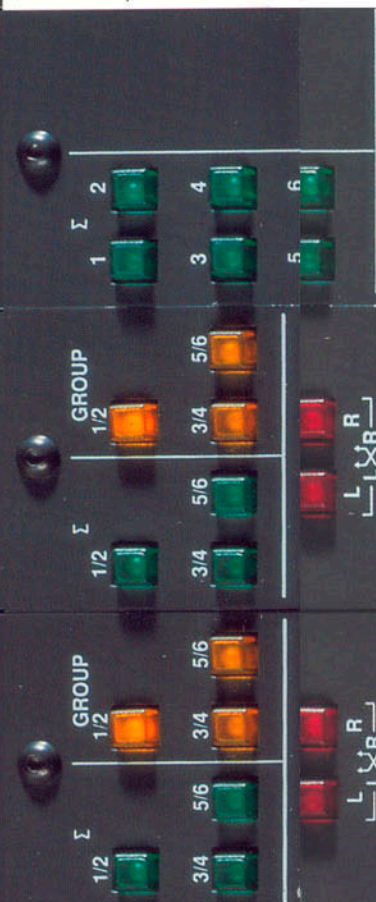
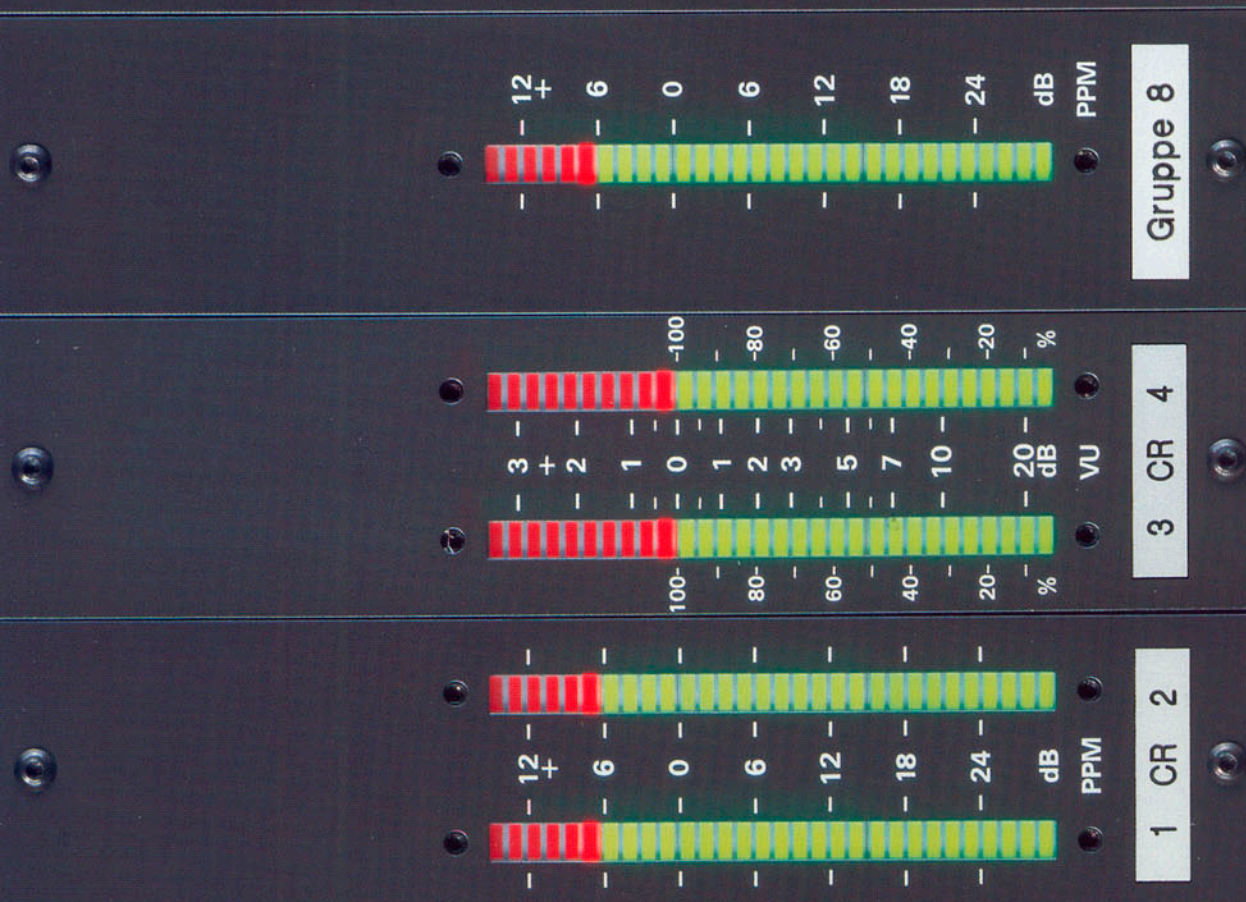

Film/HDTV Module

The STUDER 980 mixing console is basically available in two versions:

- «Broadcast» version comprising eight group and four master channels,
- «Film» version with six group and six master channels. Suitable for productions with multichannel sound according to various surround techniques.

For both units, mono input modules are available in mono and various stereo versions; in the «Film» version they differ only with respect to the group and master selection. When this page is closed you see the «Film» version, when it is folded out you see the «Broadcast» version.

Broadcast / Recording Module

AUX master Module 1.980.310

(with transformer balanced outputs 1.980.320)



Group module 1.980.230

(for film/HDTV 1.980.231)

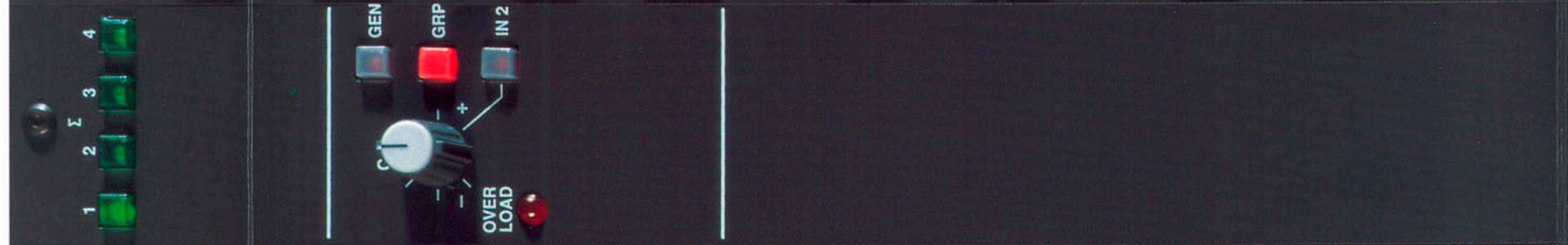

Stereo HL module without equalizer 1.980.242

(for film/HDTV 1.980.243)

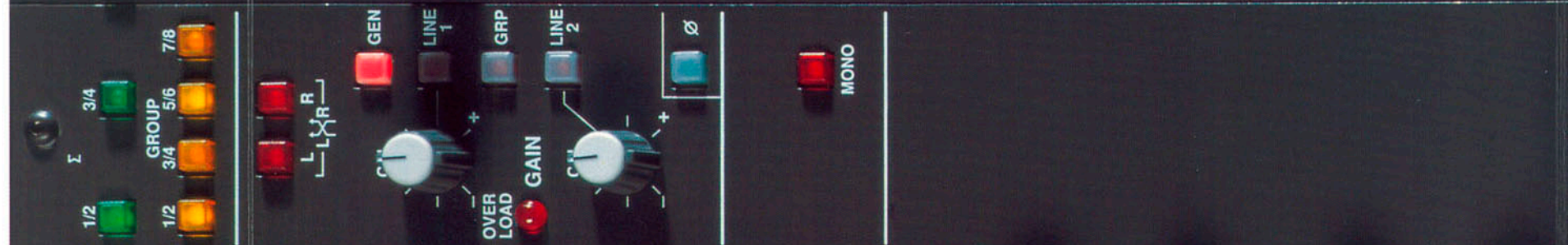

Stereo HL input module 1.980.240

(for film/HDTV 1.980.241)



Stereo universal module 1.980.250

(for film/HDTV 1.980.251)



Mono module 1.980.220

(for film/HDTV 1.980.221)



EQUALIZER (30-100 Hz)

INSERT (red) IN (red)

AUX 1 (red) PRE ON

AUX 2 (yellow) PRE ON

AUX 3 (green) PRE ON

AUX 4 (blue) PRE ON

AUX 5 (white) PRE ON

AUX 6 (white) PRE ON

AUX 7 (white) PRE ON

AUX 8 (white) PRE ON

5/6 PAN BAL 1/2

7/8 PAN BAL 1/2

DIR OUT PRE N-1

DIVERGENCE 0

FRONT REAR

PAN DIV

EQUALIZER (30-50 Hz)

INSERT (red) IN (red)

AUX 1 (red) PRE ON

AUX 2 (yellow) PRE ON

AUX 3 (green) PRE ON

AUX 4 (blue) PRE ON

AUX 5 (white) PRE ON

AUX 6 (white) PRE ON

AUX 7 (white) PRE ON

AUX 8 (white) PRE ON

5/6 PAN BAL 1/2

7/8 PAN BAL 1/2

DIR OUT PRE N-1

CAL

EQUALIZER (30-100 Hz)

INSERT (red) IN (red)

AUX 1 (red) PRE ON

AUX 2 (yellow) PRE ON

AUX 3 (green) PRE ON

AUX 4 (blue) PRE ON

AUX 5 (white) PRE ON

AUX 6 (white) PRE ON

AUX 7 (white) PRE ON

AUX 8 (white) PRE ON

5/6 PAN BAL 1/2

7/8 PAN BAL 1/2

DIR OUT PRE N-1

CAL

EQUALIZER (30-600 Hz)

INSERT (red) IN (red)

AUX 1 (red) PRE ON

AUX 2 (yellow) PRE ON

AUX 3 (green) PRE ON

AUX 4 (blue) PRE ON

AUX 5 (white) PRE ON

AUX 6 (white) PRE ON

AUX 7 (white) PRE ON

AUX 8 (white) PRE ON

5/6 PAN BAL 1/2

7/8 PAN BAL 1/2

DIR OUT PRE N-1

CAL

EQUALIZER (30-600 Hz)

INSERT (red) IN (red)

AUX 1 (red) PRE ON

AUX 2 (yellow) PRE ON

AUX 3 (green) PRE ON

AUX 4 (blue) PRE ON

AUX 5 (white) PRE ON

AUX 6 (white) PRE ON

AUX 7 (white) PRE ON

AUX 8 (white) PRE ON

5/6 PAN BAL 1/2

7/8 PAN BAL 1/2

DIR OUT PRE N-1

CAL

AUX 5+6

SEND (green) TB (orange)

PFL (green)

2CH (red)

BAL/SEND (white) R (white)

SEND (blue) 0-9

AUX 7+8

SEND (green) TB (orange)

PFL (green)

2CH (red)

BAL/SEND (white) R (white)

SEND (blue) 0-9

dB +2 0 -6 -20

dB +2 0 -6 -20

Faders

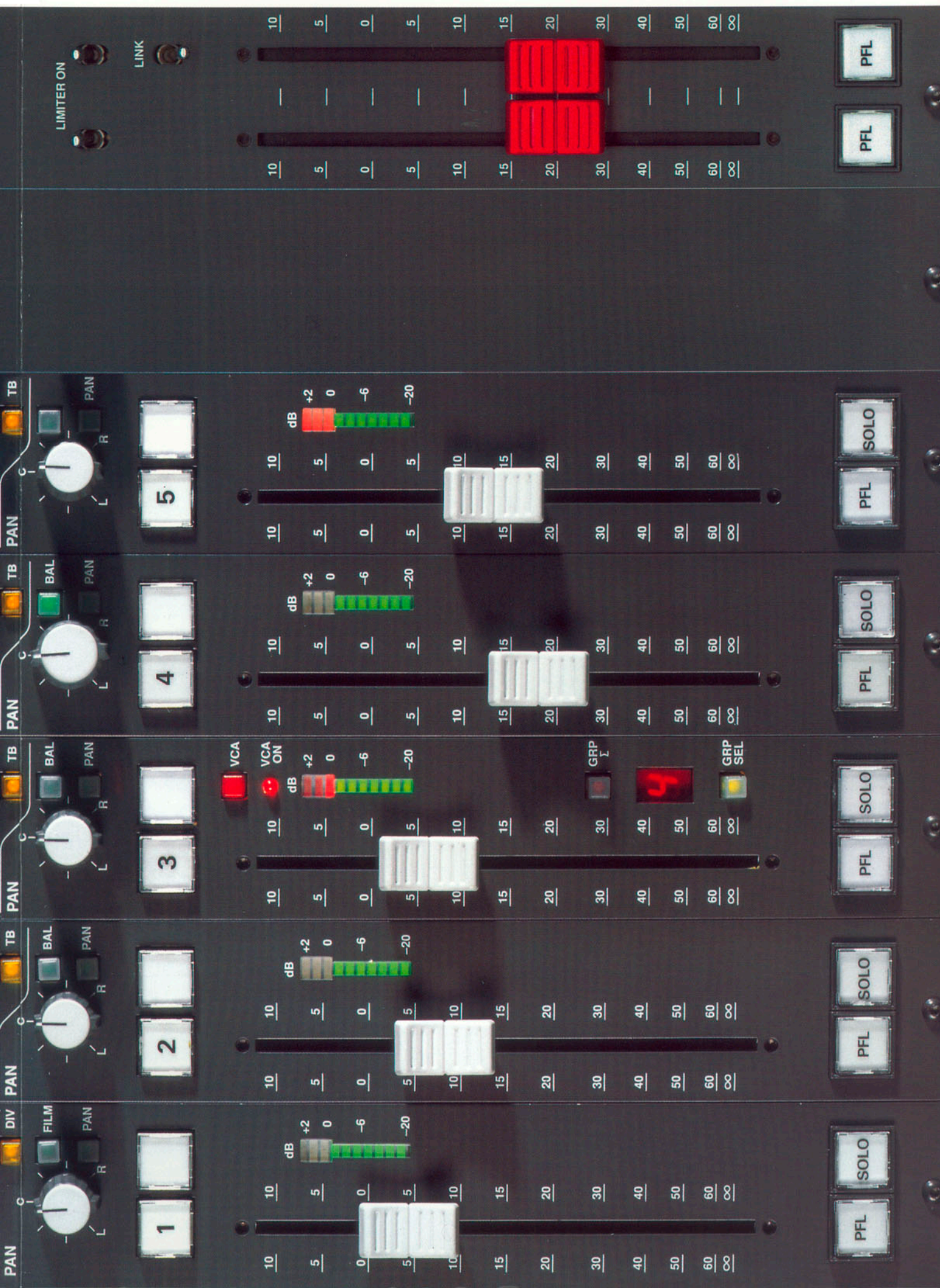

Stereo master fader 1.980.181

available also without limiter switch (1.980.180)
or two link switches (1.980.182)

Mono fader 1.980.110

also available as VCA fader (1.980.130) or as
motor fader (1.980.150)
film/HDTV version 1.980.111 (or 131 and 151 respectively)

Stereo fader with motor drive 1.980.160

Stereo fader with VCA 1.980.140

Stereo fader, normal version 1.980.120

Mono fader for film/HDTV 1.980.111

also available as VCA fader (1.980.131) or as
motor fader (1.980.151)

Special Units



H MIN SEC 1/10



START STOP RESET LAPTIME



AUTO-RESTART

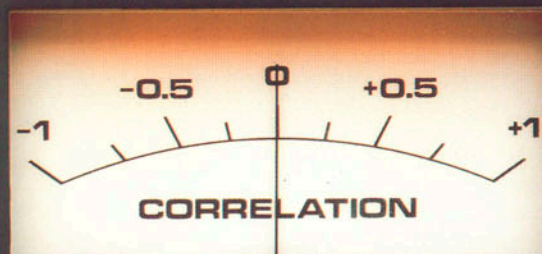

$\Sigma 1-2$
MON L-R

$\Sigma 3-4$



GR 3



The large number of available special modules makes it easy to adapt the mixing console to a variety of applications. Almost 200 such modules are available.

The following summary shows only a small selection.

The special modules with a length of 170 mm include, for example:

- Stopwatch 1.913.310
- Pointer-type correlation meter 1.913.211
- Pointer-type peak voltage meter 1.913.221
- Test generator 1.913.150
- Remote control for tape recorders 1.913.503

A special dynamic unit with a height of 85 mm is available that contains a limiter, compressor, and a gate. It can be installed above any channel unit; also central installation with patch panel distribution to individual stages is feasible. The most important static and dynamic parameters can be set. Automatic operation is available. Part No.: 1.990.510

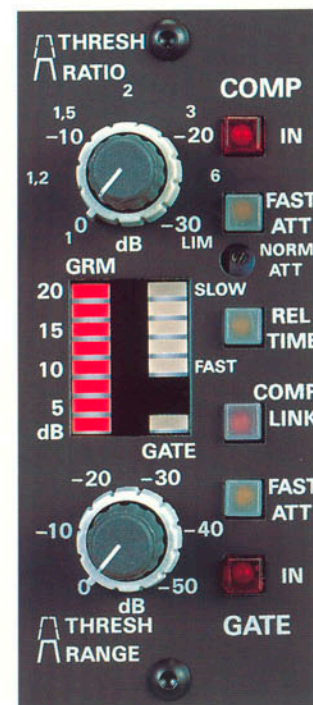



The special modules with a length of 190 mm include, for example:

- Remote control unit for R-DAT or CD player, 1.328.660
- Remote control unit for tape machines, 1.328.255
- Remote control unit with track and time indication, 1.630.900

Special Units



- Four-way output meter (bargraph) with track indication for the routing of outputs to a multitrack machine. With the aid of a relay board the 980 console can be extended to a multitrack production console. Also in-line versions are feasible.
Part No.: 1.990.609.00

STUDER

STUDER

Control panel for the control room (top) with the following buttons from left to right:

- PFL / P SOLO
- AUX 4
- AUX 3
- AUX 2
- AUX 1
- PROGR
- EXT 4
- EXT 3
- EXT 2
- EXT 1
- TAPE 2

Control panel for the studio (center) with the following buttons from left to right:

- PFL / P SOLO
- AUX 4
- CR MONIT
- Σ 3+4
- Σ 1+2
- PROGR
- PRESEN (green button)

Rotary knob with positions 0 through 9. A red indicator light labeled "CUT" is positioned below the knob.

STUDIO section with two buttons: SLATE (red) and E (orange).

MONITOR SELECTOR

MONITOR SELECTOR panel with columns for MONO, STEREO, and MCH.

MONO	STEREO	MCH
AUX 1	PFL / P-SOLO	REC 3 6CH
AUX 2	EXT 5 2CH	REC 2 6CH
AUX 3	EXT 6 2CH	REC 1 6CH
AUX 4	EXT 3 2CH	GR 1..6
AUX 5	EXT 4 2CH	Σ 1..6
AUX 6	EXT 2 2CH	DOLBY 4-2-4
AUX 7	AUX 7+8	TV 3-2
AUX 8	GR 5+6	
	GR 3+4	
	GR 1+2	

Note: The "PFL TO MON" button in the STEREO column is highlighted in orange.

Different monitoring versions are available for the mixing console. In the «Broadcast» version the standard modules for the control room (top) and studio (center) are normally used. The latter module also contains the control elements for the talkback channel.

Monitoring



For the «Film» version a special monitor panel (bottom) is available. A source matrix allows monitoring of the mixing console information in mono to six-channels as well as monitoring of the surround channels in direct, encoded and decoded form and consequently offers quality control of the recording via the Codec links. The selected signal paths are clearly marked by LEDs. Individual speakers can be turned on and off. This panel is also able to control the near-field monitors.

Block Diagram

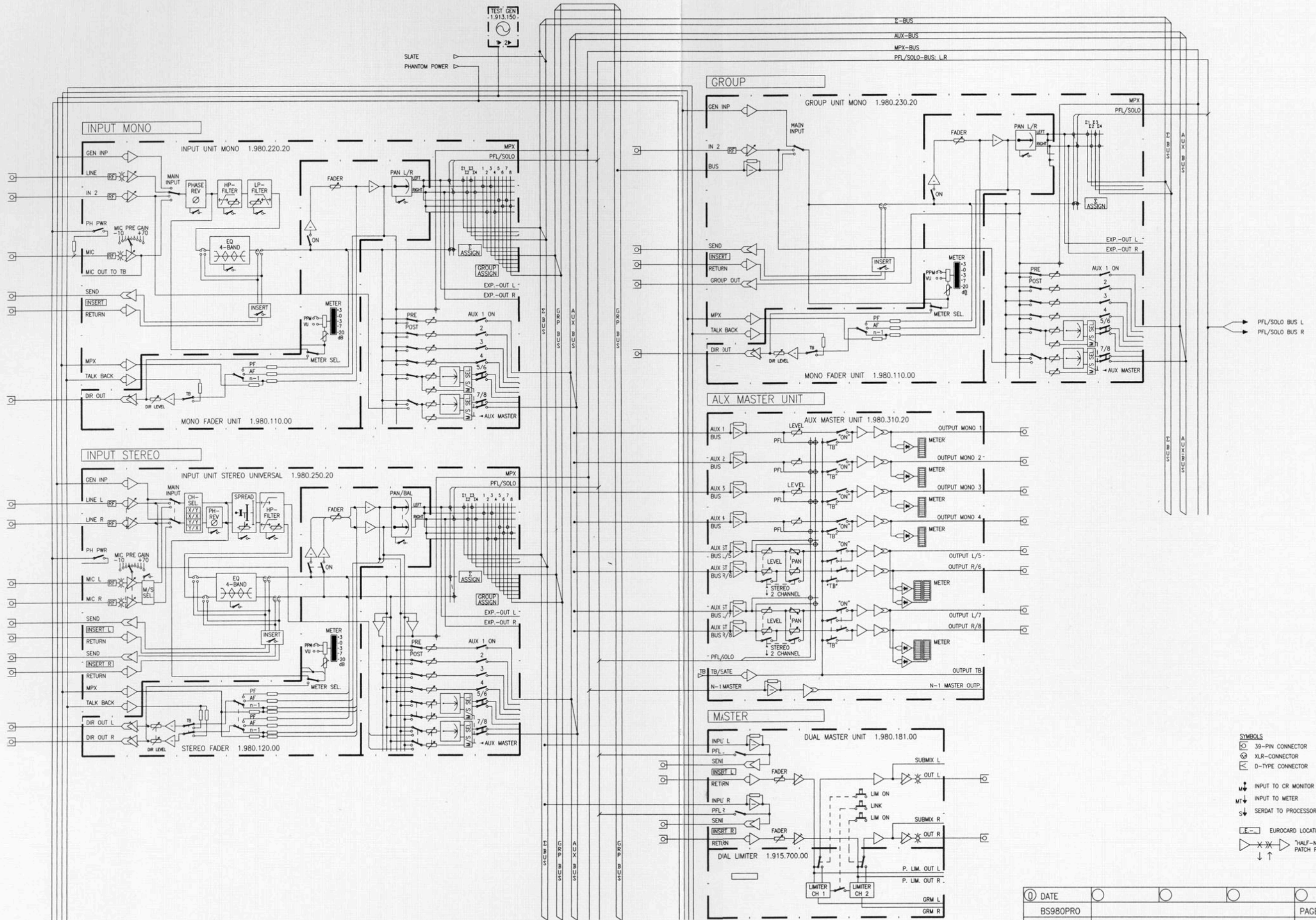

- SYMBOLS**
- 39-PIN CONNECTOR
 - XLR-CONNECTOR
 - D-TYPE CONNECTOR
 - INPUT TO CR MONITOR
 - INPUT TO METER
 - SERDAT TO PROCESSOR UNIT
 - EUROCARD LOCATION
 - HALF-NORMALLED PATCH POINT

DATE			
BS980PRO			PAGE 1 OF 2
STUDER REGENSDORF SWITZERLAND	STUDER 980 AUDIO BLOCK DIAGRAM		1.980.000

Snapshot automation

EXTERN MUTE UPTOWN METER ON INPUT PFL-MODE ALL n SOLO DESTR SOLO SAVE TALK TO ALL

MEMORY CARD

SNAPSHOT RECALL
Select Snap to recal
STOR NAME DEL

PRESET F 1 F 2 F 3 F 4 ↑ MENU
RANGE CANCEL ← → EXEC

STANDARD					FILM				
1	2	3	4	5	6	7	8	9	10
Σ1	Σ2	Σ3	Σ4			Σ1	Σ2	G1	G2
1	2	3	4	5	6	7	8	9	0
11	12	13	14	15	16	17	18	19	20
G1	G2	G3	G4			Σ3	Σ4	G3	G4
Q	W	E	R	T	Y	U	I	O	P
21	22	23	24	25	26	27	28	29	30
G5	G6	G7	G8			Σ5	Σ6	G5	G6
A	S	D	F	G	H	J	K	L	-
31	32	33	34	35	36	37	38	39	40
/	Z	X	C	V	B	N	M		BLANK

Snapshot automation

On the Studer 980 all switch functions can be controlled through automation. A snapshot of the momentary mixing console state is stored. Different snapshots can be linked into sequences. Snapshots or sequences can be recalled as desired.

Identification labels can be assigned to the individual snapshots or sequences. These labels are entered either automatically or via a keyboard with a QWERTZ layout.

The same keyboard is also used for assigning the input stages to the groups, masters or multitrack buses.

The automation is menu controlled via softkeys.

Dynamic automation

Dynamic control of the channel faders and the MUTE switches is available as an option.

«Top layer» automation

The automation functions in a «top layer» configuration, that is, it is superposed on the manual operating level. For this reason automated mixing consoles can be operated without automation at any time, be it on request of the operator or in case of a malfunction.

PCMCIA memory cards

Snapshots and sequences can be stored on modern and very convenient PCMCIA cards. In this way each sound engineer can save his personal snapshots and sequences on an external medium. Nothing could be easier!

Superb microphone input circuit

Maximum dynamic range, freedom of distortion as well as minimal basic noise were the design specifications of an input stage for the digital age. This objective has been met, the circuitry has been patented (USA, Europe and Japan).

Ratings: Lowest distortions within the entire dynamic range from -74 to $+24$ dBu, the impedance remains constant across the entire frequency range, and the noise figure is only about 3 to 4 dB. These perfect data have been achieved with a dual system of very small transformers and an actively controlled flux density.

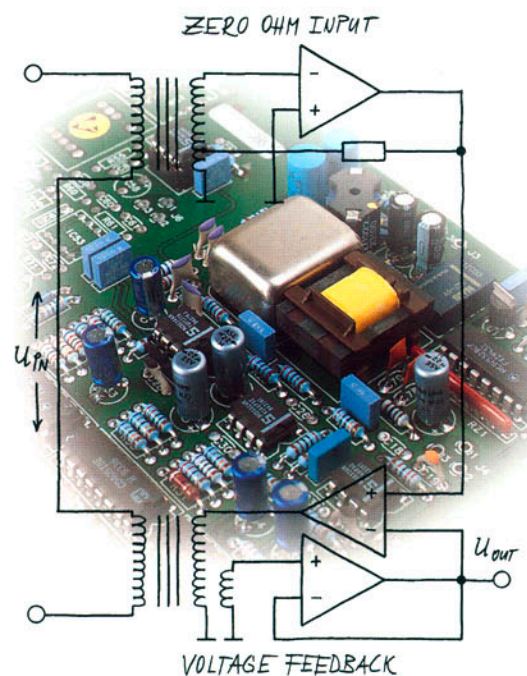

Functions

HDTV / Film

Output selection of 6 groups and 6 masters.

Mono module: MIC input level -74 to +24 dBu; 2 line inputs, generator.

Stereo high level module: 2 Stereo line inputs, generator Channel selection/channel swapping/stereo width.

Filter selection: Mono: High and low pass filter; Stereo: High pass filter

Equalizer: 4-Band equalizer with shelving/peaking at the lower and upper frequencies. Q-changeover at the medium frequencies.

4 mono AUX outputs plus either 2 stereo or 4 additional mono AUX outputs.

Stereo high level input unit with equalizer >
Mono microphone input unit with equalizer >>

With the special HDTV/film faders it is possible to distribute and pan a mono signal to 4, 5 or 6 output channels. The width of the frontal sound image can be additionally modified with the divergence potentiometer. Direct output and «N-1» circuit are preserved in simplified form.

Stereo VCA fader >
Mono VCA fader >>

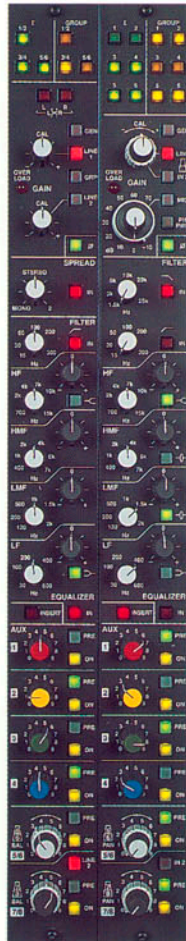

New modules, specially designed for the latest requirements

These mixing consoles out of the 980 series have been built in the uncluttered and ergonomically favorable 40 mm format. To complement the existing compatible input and fader modules, several sets of new, specialized modules have been developed. These are perfectly matched to the current and future function requirements of live and post productions in:

- Radio broadcasting
- Public address systems
- Dolby Surround™
- HDTV Video
- Film

Radio Broadcasting/ PA Systems

Output selection with up to 8 groups and 4 masters.

Mono module: MIC input level -74 to +24 dBu; 2 line inputs, generator.

Stereo module: MIC input level -74 to +24 dBu, with XY/MS changeover, line input, generator, channel selection/channel swapping/stereo width.

Filter selection: Mono: high and low pass filter; Stereo: High pass filter

Equalizer: 4-Band equalizer with shelving/peaking at the lower and upper frequencies. Q-changeover at the medium frequencies.

4 mono AUX outputs plus either 2 stereo or 4 additional mono AUX outputs.

<< Mono microphone input unit
< Stereo microphone/ high level input unit

Particular attention has been given not only to the influencing of the level by the fader, but also to the output distribution. The stereo fader can be changed over between panorama and balance function. The direct output can be connected before or after the fader; «N-1» can be activated on any channel. There is a central facility that controls whether all channels or only those with selected «N-1» function are to be added.

<< Mono fader
< Stereo fader



Dimensions

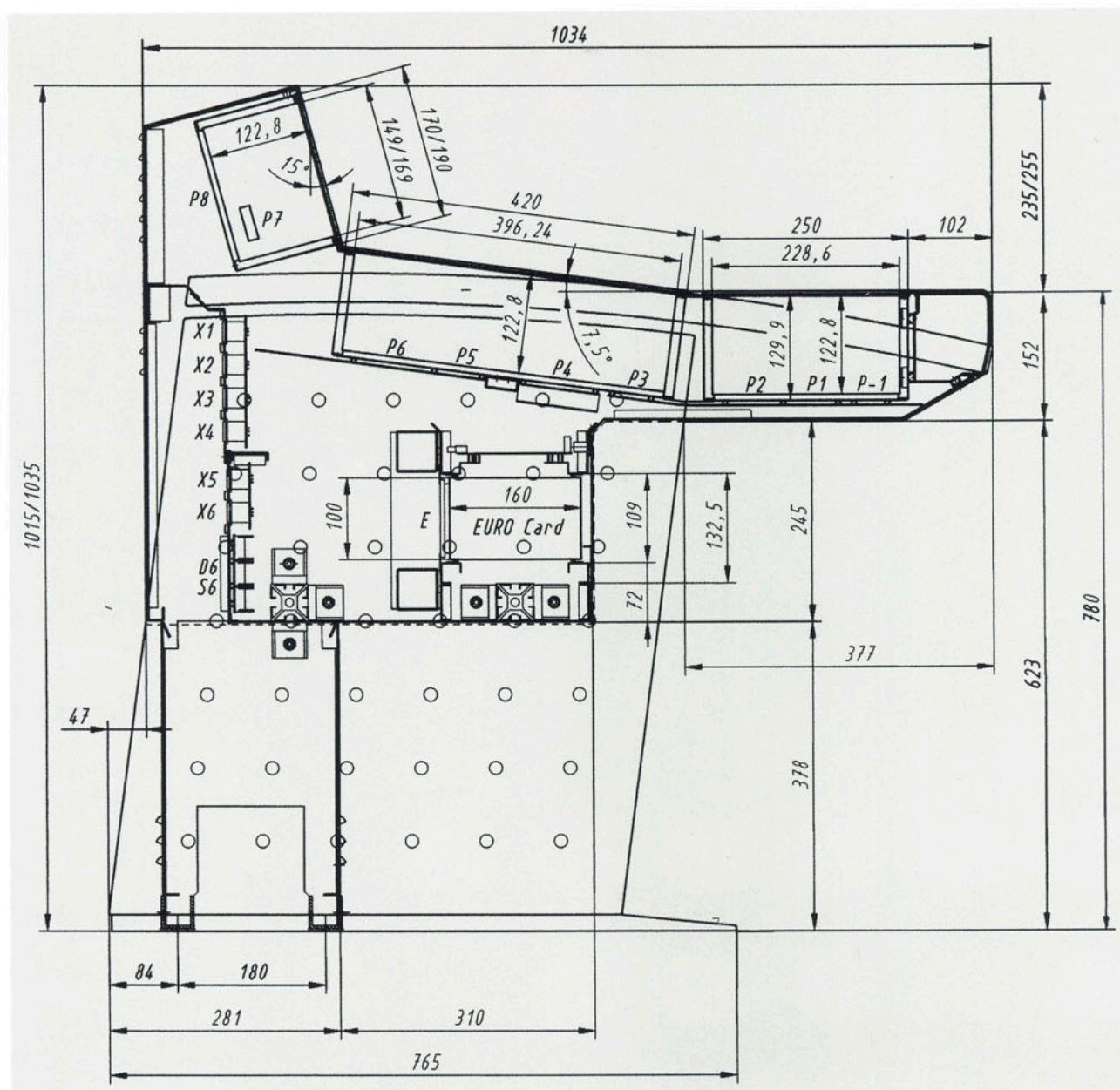

Dolby Surround is a registered trademark of Dolby Laboratories Inc.

Subject to change.
 STUDER is a registered trade mark of
 STUDER Professional Audio AG
 Printed in Switzerland 10.26.3120 (Ed. 1096)
 Copyright by STUDER Professional Audio AG

STUDER
 PROFESSIONAL AUDIO EQUIPMENT

STUDER Professional Audio AG, Althardstrasse 30, CH-8105 Regensdorf-Zurich
 Switzerland, Telephone +41 1 870 75 11, Telefax +41 1 840 47 37

For more information please contact:

Austria: +43 1 866 54-0
 France: +33 1 45 14 47 86
 Germany: +49 30 72 39 34-0
 U.K.: +44 181 207 50 50
 or your local representative

Canada: +1 416 510 13 47
 Japan: +81 3 34 65 22 11
 Singapore: +65 225 51 15
 USA: +1 615 399 21 99

H A Harman International Company